



Features

- Heavy-duty auxiliary heater
- Heavy-duty steel construction
- (1) 2-speed motor
- (2) Universal mounting brackets

Suggested Applications



Technical Specifications

| Model | KH-200 12V | KH-200 24V |
|------------------------|---|---|
| Voltage | 12V | 24V |
| Power | 18,360 BTU/hr (5,4 kW) | 18,360 BTU/hr (5,4 kW) |
| Amps | 1.53 A | 1.5 A |
| Maximum air flow | 145 SCFM (246 m³/hr) | 145 SCFM (246 m³/hr) |
| Dimensions (W x H x D) | 11.3in x 6.4in x 7.5in (286mm x 162mm x 189mm) | 11.3in x 6.4in x 7.5in (286mm x 162mm x 189mm) |
| Weight | 9 lbs. (4,1 kg) | 9 lbs. (4,1 kg) |
| Mounting Position | Floor or Wall | Floor or Wall |
| Tube Connection | (2) 5/8" O.D. | (2) 5/8" O.D. |

Measurements are listed using the U.S. system with the metric system in parenthesis.

Dimensions layout

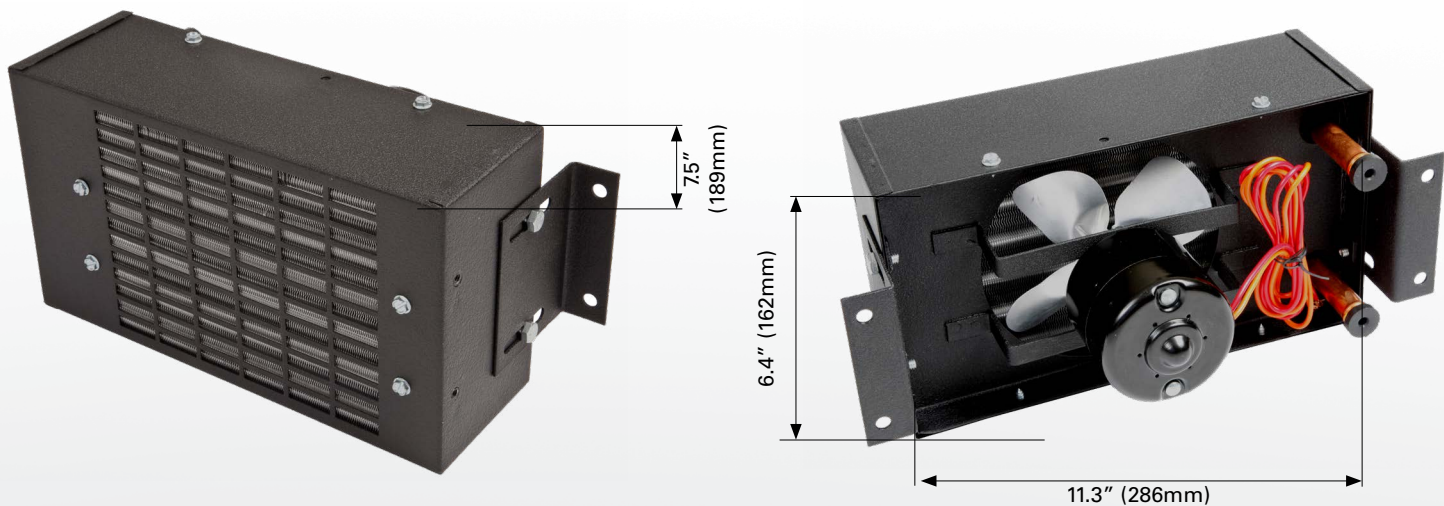

Line Drawing

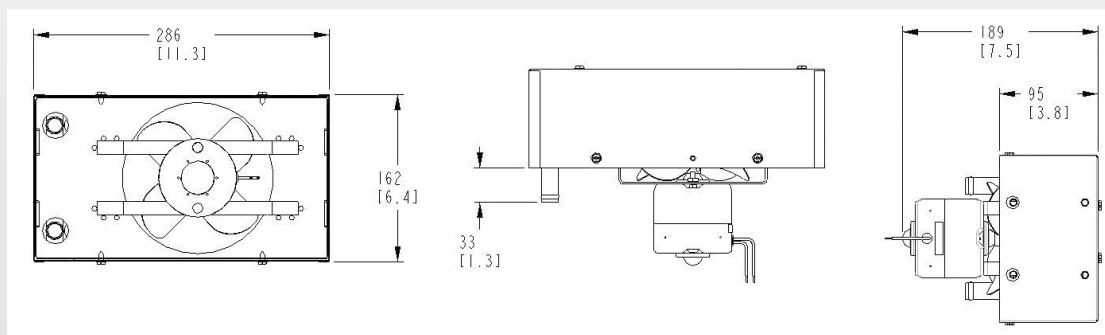

KH-200 Order Guide

| Part | Catalog / Part Number | Notes |
|------------------|--|------------|
| Unit Part Number | 1000258379 / 1000258379 1000258381 / 1000258381 | 12V 24V |

KH-200 Service Parts Guide

| Part | Catalog / Part Number | Notes |
|--------------------|---|------------|
| Blower Motor | 1075005 / 1000182193 1075006 / B274284 | 12V 24V |
| Blower Fan | 1275004 / B265620 1275004 / B265620 | 12V 24V |
| Motor Guard Kit | 3475034 / B416616 3475034 / B416616 | 12V 24V |
| Control Switch Kit | 3475035 / B416617 3475035 / B416617 | 12V 24V |



When placing an order please contact your sales representative to review your order to ensure the proper system has been identified for your vehicle application.

Availability of the products shown in this catalog is subject to change without notice by Bergstrom, Inc. For the most current product information please visit the Kysor distributor website at <https://parts.shop.bergstrominc.com/>.

Warranty

- 1-year limited warranty